

**PAVILION HALL (GROUND FLOOR)**

**INTERNATIONAL ZONE**

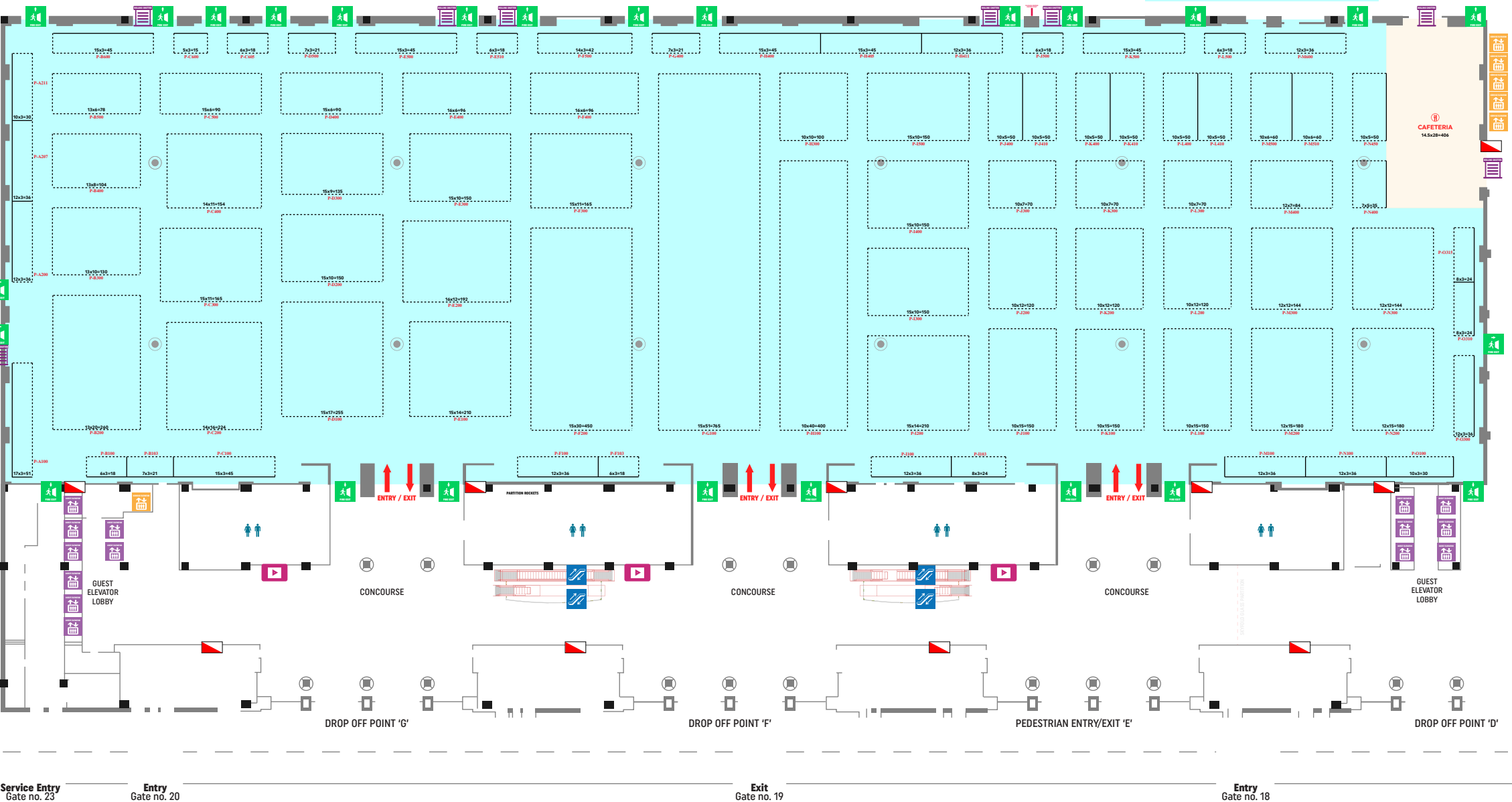

**JASMINE HALL (3rd FLOOR)**

**INTERNATIONAL ZONE**

**GLOBAL VILLAGE ZONE**

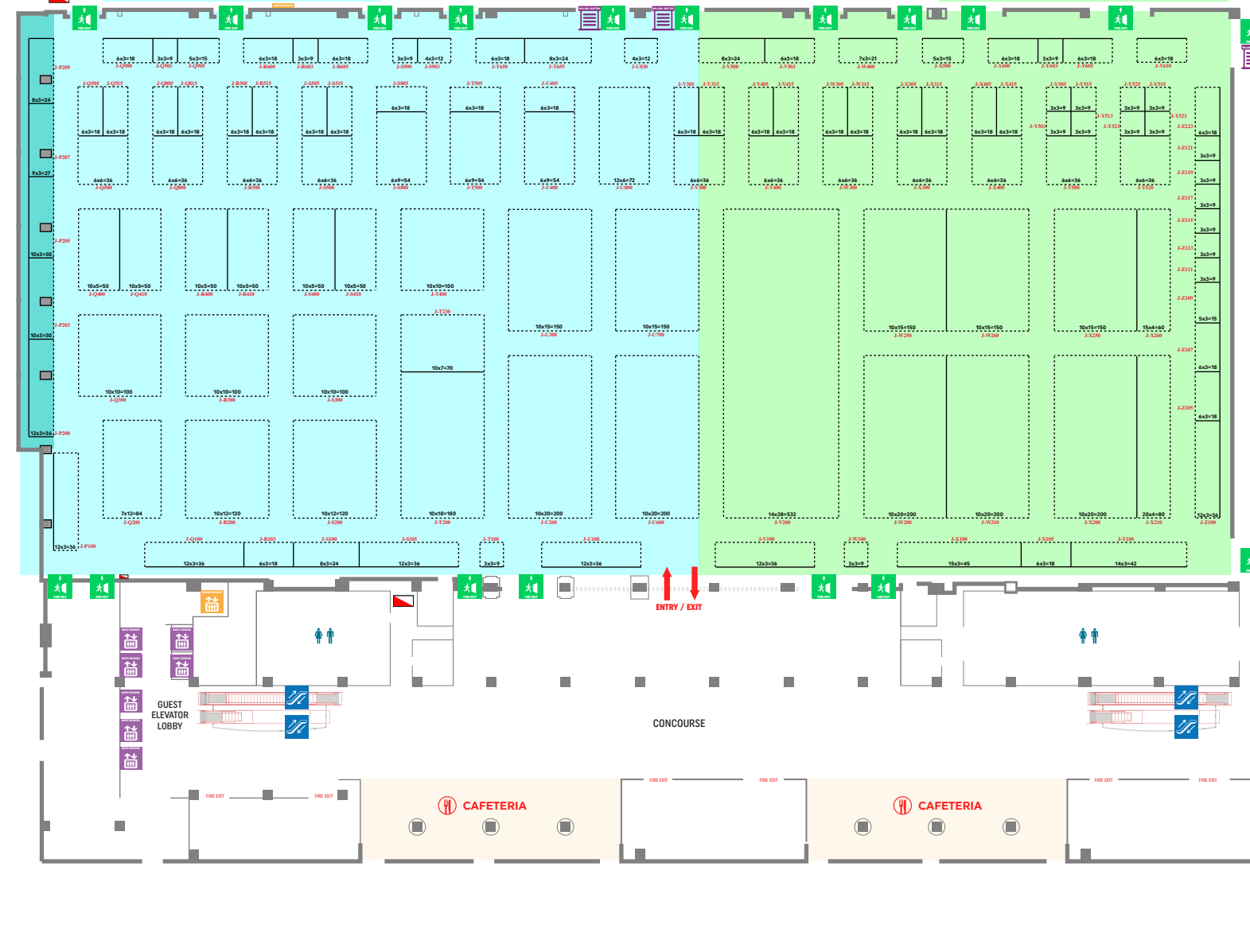

**ICON INDEX**

- Pillar: Tree Column Diagram ((1.1m (w) x 12.4m (h))
- ⊗ Hanging Points (500kgs)
- Floor Utility boxes
- For Pavilion: (AV, IT, Power, Water, Supply, Drain, Compressed Air)
- For Jasmine: (AV, IT & Power)

**TREE COLUMN DIAGRAM**

**Important note for Pavilion & Jasmine hall: Bare space minimum 18 sqm & above.**

\* Fairfest Media Limited reserves right to amend the exhibition floor plan & is not responsible for any change due to unforeseen circumstances.

**ICON INDEX FOR JASMINE HALL**

- Pillar: Square Column Diagram (1m (w) x 1.5m (d) x 9.5 feet (h))
- Maximum Height allowed - 2.9 mtrs (9.5 feet)
- International
- Global Village